

Laidlaw College – 3 Smythe Rd

Directions and Parking Instructions

Directions to Laidlaw College should pop up if you look us up via googlemaps. If not, follow the notes below the parking instructions.

South carpark:



North carpark:



Parking instructions at 3 Smythe Rd

Laidlaw College has 2 marked parking lots at 3 Smythe Rd: one just off Smythe Rd on the south side of the building. The other just off Te Ara Pūheke on the north side adjacent to the Japanese Gardens. Students and staff need to display their permit when parked in these areas. Be sure to park in the red Laidlaw zones indicated on the map. Please reserve the other parking areas for their designations.

Laidlaw students & staff: Green parking permits need to be displayed on car windscreen when in Laidlaw parking areas (red on map).

Block course students & visiting staff: Students or staff on campus for a few consecutive days can get a temporary (gold) permit to display on their dashboard with the dates of their stay. These are issued from the Welcome Pod (Te Wāhi Maioha)

All other visitors:

Any other guests or visitors who park in the Laidlaw car park need to register their licence plate when signing in at Te Wāhi Maioha. Otherwise, 120 minute parking spots may be available. Public parking is in the green area and can be paid via the Inpark app (\$3/day).

DIRECTIONS TO 3 SMYTHE RD - with maps

If you are coming from the **NORTH** and the location of our old 80 Central Park Drive campus, head down Alderman Drive, towards the Waitakere Ranges. You will cross over Great North Road and onto Henderson Valley Rd, then go under a railway bridge.

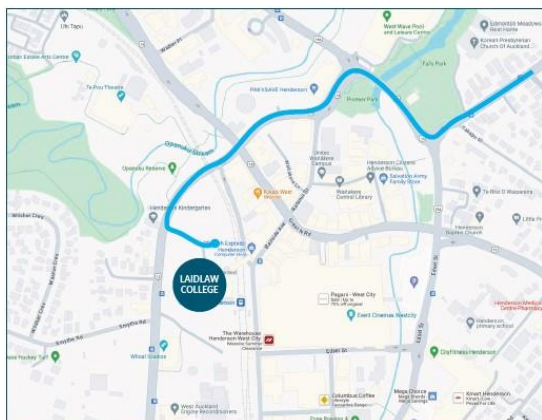

North car park: Take your first left onto Te Ara Pūheke, drive up the road and turn left into the parking lot. (red zone on map)

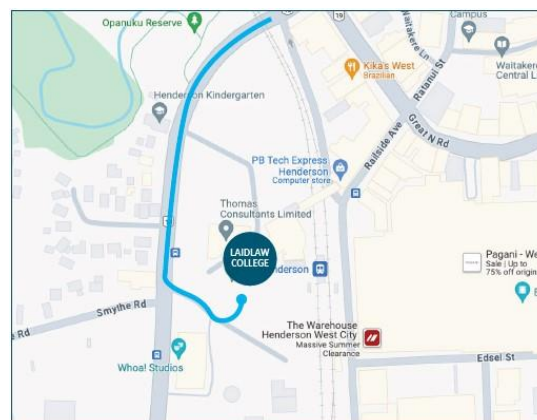

South car park: Turn left at the lights onto Smythe Rd and take your first left towards the building. You will see signs for the Laidlaw College car park on your right side. (red zone)

If you are coming from the **SOUTH / Henderson Valley**, drive past Henderson High School, then turn right off Henderson Valley Rd onto Smythe Rd. Take a left at #3 towards the building. You will see signs for the Laidlaw College car park (south) on your right side.

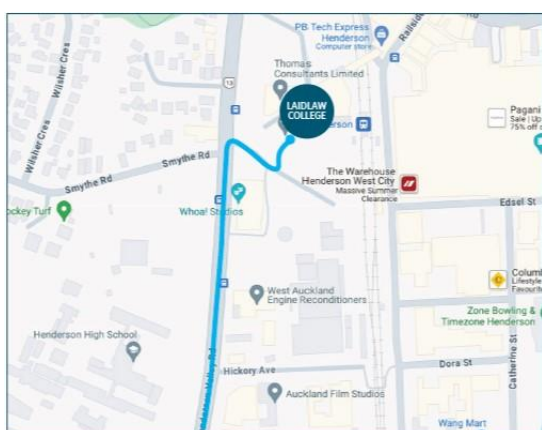

South car park: On your right side in a V - shape (red zone on map)

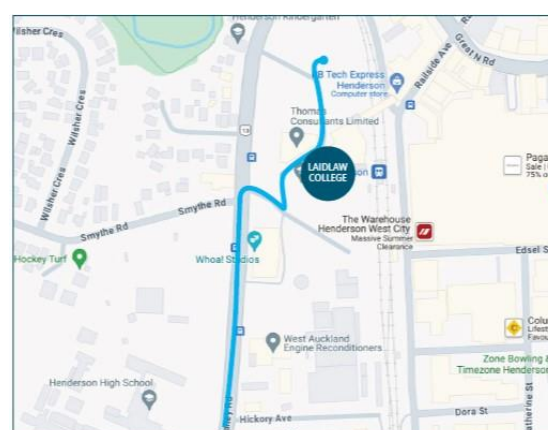

North car park: From Smythe Rd, take a left onto Te Ara Pūheke. Drive between the 2 buildings, past Café Ebenezer, and turn right into the parking lot – beside the Japanese Gardens. (red zone)

Laidlaw College Main Entrance

Our main entrance is on Level 1 at the top of the stairs by the pou – across from Café Ebenezer. There is a public lift to the left of the stairs.



If you are visiting, please sign in at our Welcome Pod (Te Wāhi Maioha), and we can answer questions and point you in the right direction from there.

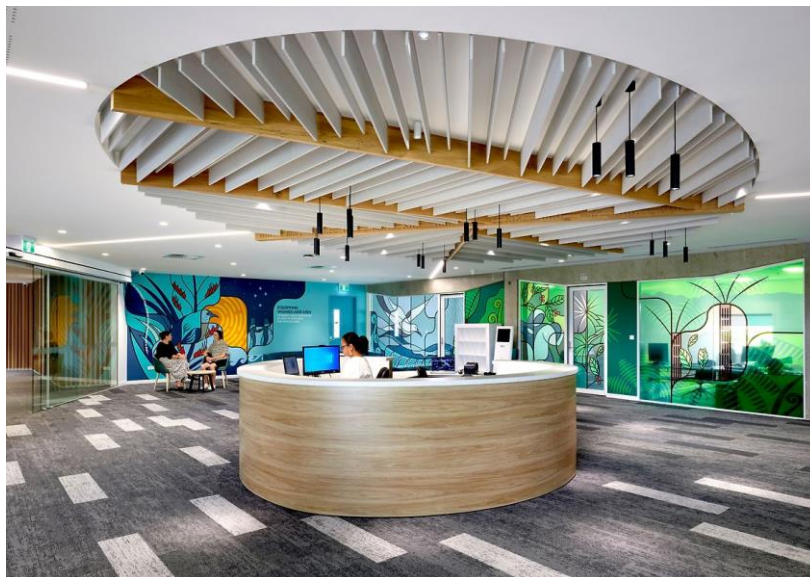

We look forward to seeing you on campus!

The Laidlaw College Staff Team